

# EZsnap® Grommet

June 2025

## Installation Instructions

12-inch riser



6-inch riser



Detail 1

NARROW OPENING WITH  
INTERIOR TABS

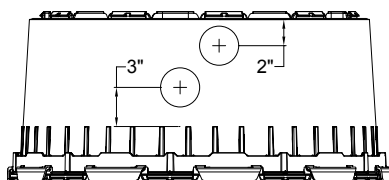

WIDE OPENING WITH  
EXTERIOR TABS

Detail 2

NARROW OPENING WITH  
INTERIOR TABS

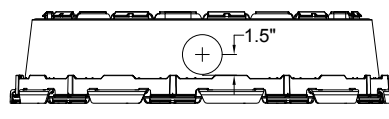

WIDE OPENING WITH  
EXTERIOR TABS

### Riser-Grommet Installation

**Note:** It is recommended to perform this installation prior to connecting the riser to a tank or to additional riser(s).

**Note:** Maximum hole size should not exceed 2-7/8".

1. Measure and mark the location of the grommet.
  - a. For the 12" riser maintain a minimum distance of 3" from the ribs at the wide opening and 2" from the narrow opening of the riser (See Detail 1).
  - b. For the 6" riser measure and mark a pilot hole measured at 1.5" from the wide opening of the riser (See Detail 2).
2. Drill hole through riser.
  - a. Use the appropriate hole saw for pipe diameter. Start with the drill in the reverse and drill until a groove has formed in the riser. Then set the drill to forward and drill opening at the pre-marked location.
  - b. Remove debris from the hole and smooth surface with knife or grinder.
3. Set appropriately sized grommet into opening.
4. Attach riser to tank.
  - a. For IM-Tanks follow Infiltrators IM-Series Tank Riser Connection Guidance Document for EZsnap Risers.
5. Bevel the edge of the pipe and coat the beveled end with soapy water or a non-stick spray.
6. Set pipe into the grommet.

Contact Infiltrator's Technical Services Department for assistance at  
1-800-221-4436 or [info@infiltratorwater.com](mailto:info@infiltratorwater.com)

EZGROM01 0625

 **Infiltrator**  
Water Technologies  
Part of **ADS**

[infiltratorwater.com](http://infiltratorwater.com) • (800) 221-4436